

Voorlasflens EN1092-1 TYPE11B1 PN 6

Maatvoering	D	C2	H2	H3	S	R1	A	N1	d1	Gaten	L	K	Kg
DN 10 / 17.2 mm	75,0	12	28	6	2,0	4	17,2	26,0	35,0	4	11	50,0	0,4
DN 15 / 21.3 mm	80,0	12	30	6	2,0	4	21,3	30,0	40,0	4	11	55,0	0,4
DN 20 / 26.9 mm	90,0	14	32	6	2,3	4	26,9	38,0	50,0	4	11	65,0	0,6
DN 25 / 33.7 mm	100,0	14	35	6	2,6	4	33,7	42,0	60,0	4	11	75,0	0,7
DN 32 / 42.4 mm	120,0	14	35	6	2,6	6	42,4	55,0	70,0	4	14	90,0	1,1
DN 40 / 48.3 mm	130,0	14	38	7	2,6	6	48,3	62,0	80,0	4	14	100,0	1,3
DN 50 / 60.3 mm	140,0	14	38	8	2,9	6	60,3	74,0	90,0	4	14	110,0	1,4
DN 65 / 76.1 mm	160,0	14	38	9	2,9	6	76,1	88,0	110,0	4	14	130,0	1,8
DN 80 / 88.9 mm	190,0	16	42	10	3,2	8	88,9	102,0	128,0	4	18	150,0	2,9
DN 100 / 114.3 mm	210,0	16	45	10	3,6	8	114,3	130,0	148,0	4	18	170,0	3,4
DN 125 / 139.7 mm	240,0	18	48	10	4,0	8	139,7	155,0	178,0	8	18	200,0	4,7
DN 150 / 168.3 mm	265,0	18	48	12	4,5	10	168,3	184,0	202,0	8	18	225,0	5,5
DN 200 / 219.1 mm	320,0	20	55	15	6,3	10	219,1	236,0	258,0	8	18	280,0	8,6
DN 250 / 273.0 mm	375,0	22	60	15	6,3	12	273,0	290,0	312,0	12	18	335,0	11,7
DN 300 / 323.9 mm	440,0	22	62	15	7,1	12	323,9	342,0	365,0	12	22	395,0	15,3
DN 350 / 355.6 mm	490,0	22	62	15	7,1	12	355,6	385,0	415,0	12	22	445,0	20,3
DN 400 / 406.4 mm	540,0	22	65	15	7,1	12	406,4	438,0	465,0	16	22	495,0	23,1
DN 450 / 457.2 mm	595,0	22	65	15	7,1	12	457,2	492,0	520,0	16	22	550,0	27,0
DN 500 / 508.0 mm	645,0	24	68	15	7,1	12	508,0	538,0	570,0	20	22	600,0	30,8
DN 600 / 609.6 mm	755,0	30	70	16	7,1	12	610,0	640,0	670,0	20	26	705,0	44,0
DN 700 / 711.0 mm	860,0	30	76	16	8,0	12	711,0	740,0	775,0	24	26	810,0	53,7
DN 800 / 813.0 mm	975,0	30	76	16	8,0	12	813,0	842,0	880,0	24	30	920,0	64,4
DN 900 / 914.0 mm	1075,0	34	78	16	8,0	12	914,0	942,0	980,0	24	30	1020,0	79,2
DN 1000/1016.0 mm	1175,0	38	82	16	8,0	16	1016,0	1045,0	1080,0	28	30	1120,0	98,6



Kijk voor het complete
overzicht op onze website:

hellebeuk.nl

Hoofdkantoor en magazijn:

Hekerweg 27, 6301 RJ Valkenburg a/d Geul
Tel: +31 (0)45 - 405 16 51

Kantoor:

Morsestraat 11-J, 4004 JP Tiel
Tel: +31 (0)344 - 729 729

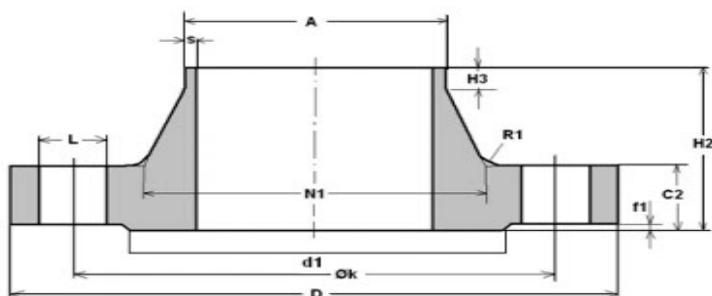

Voorlasflens EN1092-1 TYPE11B1 PN 10

Maatvoering	D	C2	H2	H3	S	R1	A	N1	d1	Gaten	L	K	Kg
DN 200 /219.1 mm	340,0	24	62	16	6,3	10	219,1	234,0	268,0	8	22	295,0	11,6
DN 250 /273.0 mm	395,0	26	68	16	6,3	12	273,0	292,0	320,0	12	22	350,0	15,8
DN 300 /323.9 mm	445,0	26	68	16	7,1	12	323,9	342,0	370,0	12	22	400,0	18,3
DN 350 /355.6 mm	505,0	26	68	16	7,1	12	355,6	385,0	430,0	16	22	460,0	25,3
DN 400 /406.4 mm	565,0	26	72	16	7,1	12	406,4	440,0	482,0	16	26	515,0	30,6
DN 450 /457.2 mm	615,0	28	72	16	7,1	12	457,2	488,0	532,0	20	26	565,0	35,1
DN 500 /508.0 mm	670,0	28	75	16	7,1	12	508,0	542,0	585,0	20	26	620,0	40,5
DN 600 /609.6 mm	780,0	30	82	18	8,0	12	609,6	642,0	685,0	20	30	725,0	52,9
DN 700 /711.0 mm	895,0	35	85	18	8,8	12	711,0	746,0	800,0	24	30	840,0	75,8
DN 800 /813.0 mm	1015,0	38	96	18	8,8	12	813,0	850,0	905,0	24	33	950,0	102,0
DN 900 /914.0 mm	1115,0	38	99	20	12,5	12	914,0	950,0	1005,0	28	33	1050,0	121,0
DN1000/1016.0 mm	1230,0	44	105	20	12,5	16	1016,0	1052,0	1110,0	28	36	1160,0	161,0



Kijk voor het complete
overzicht op onze website:

hellebeuk.nl

Hoofdkantoor en magazijn:

Hekerweg 27, 6301 RJ Valkenburg a/d Geul
Tel: +31 (0)45 - 405 16 51

Kantoor:

Morsestraat 11-J, 4004 JP Tiel
Tel: +31 (0)344 - 729 729

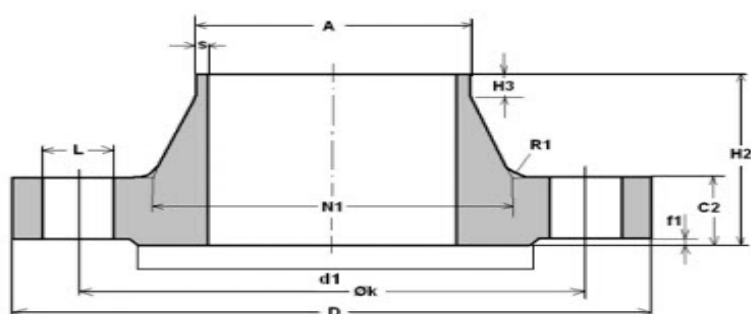

Voorlasflens EN1092-1 TYPE11B1 PN 16

Maatvoering	D	C2	H2	H3	S	R1	A	N1	d1	Gaten	L	K	Kg
DN 50 / 54.0 mm	165,0	18	45	8	2,0	6	54,0	72,0	102,0	4	18	125,0	2,5
DN 50 / 57.0 mm	165,0	18	45	8	2,9	6	57,0	72,0	102,0	4	18	125,0	2,5
DN 50 / 60.3 mm	165,0	18	45	8	2,9	6	60,3	74,0	102,0	4	18	125,0	2,5
DN 65 / 70.0 mm	185,0	18	45	10	2,9	6	70,0	92,0	122,0	4	18	145,0	3,0
DN 65 / 70.0 mm	185,0	18	45	10	2,9	6	70,0	92,0	122,0	8	18	145,0	3,0
DN 65 / 76.1 mm	185,0	18	45	10	2,9	6	76,1	92,0	122,0	4	18	145,0	3,0
DN 65 / 76.1 mm	185,0	18	45	10	2,9	6	76,1	92,0	122,0	8	18	145,0	3,0
DN 80 / 84.0 mm	200,0	20	50	10	3,2	6	84,0	105,0	138,0	8	18	160,0	4,0
DN 80 / 88.9 mm	200,0	20	50	10	3,2	6	88,9	105,0	138,0	8	18	160,0	3,9
DN 100 / 104.0 mm	220,0	20	52	12	3,6	8	104,0	125,0	158,0	8	18	180,0	4,5
DN 100 / 108.0 mm	220,0	20	52	12	3,6	8	108,0	125,0	158,0	8	18	180,0	4,5
DN 100 / 114.3 mm	220,0	20	52	12	3,6	8	114,3	131,0	158,0	8	18	180,0	4,5
DN 125 / 129.0 mm	250,0	22	55	12	4,0	8	129,0	150,0	188,0	8	18	210,0	6,5
DN 125 / 133.0 mm	250,0	22	55	12	4,0	8	133,0	150,0	188,0	8	18	210,0	6,5
DN 125 / 139.7 mm	250,0	22	55	12	4,0	8	139,7	156,0	188,0	8	18	210,0	6,3
DN 150 / 154.0 mm	285,0	22	55	12	4,5	10	154,0	175,0	212,0	8	22	240,0	8,0
DN 150 / 156.0 mm	285,0	22	55	12	4,5	10	156,0	175,0	212,0	8	22	240,0	8,0
DN 150 / 159.0 mm	285,0	22	55	12	4,5	10	159,0	175,0	212,0	8	22	240,0	8,0
DN 150 / 168.3 mm	285,0	22	55	12	4,5	10	168,3	184,0	212,0	8	22	240,0	8,0
DN 200 / 219.1 mm	340,0	24	62	16	6,3	10	219,1	235,0	268,0	12	22	295,0	11,5
DN 250 / 273.0 mm	405,0	26	70	16	6,3	12	273,0	292,0	320,0	12	26	355,0	16,7
DN 300 / 323.9 mm	460,0	28	78	16	7,1	12	323,9	344,0	378,0	12	26	410,0	22,1
DN 350 / 355.6 mm	520,0	30	82	16	8,0	12	355,6	390,0	438,0	16	26	470,0	32,8
DN 400 / 406.4 mm	580,0	32	85	16	8,0	12	406,4	445,0	490,0	16	30	525,0	41,1
DN 450 / 457.2 mm	640,0	34	83	16	8,0	12	457,2	490,0	550,0	20	30	585,0	50,6
DN 500 / 508.0 mm	715,0	36	84	16	8,0	12	508,0	548,0	610,0	20	33	650,0	74,0
DN 600 / 609.6 mm	840,0	40	88	18	10,0	12	609,6	652,0	725,0	20	36	770,0	96,5
DN 700 / 711.0 mm	910,0	40	104	18	10,0	12	711,0	755,0	795,0	24	36	840,0	104,0
DN 800 / 813.0 mm	1025,0	41	108	20	12,5	12	813,0	855,0	900,0	24	39	950,0	122,0
DN 900 / 914.0 mm	1125,0	48	118	20	12,5	12	914,0	955,0	1000,0	28	39	1050,0	155,0
DN1000/1016.0 mm	1255,0	59	137	22	12,5	16	1016,0	1058,0	1115,0	28	42	1170,0	233,0

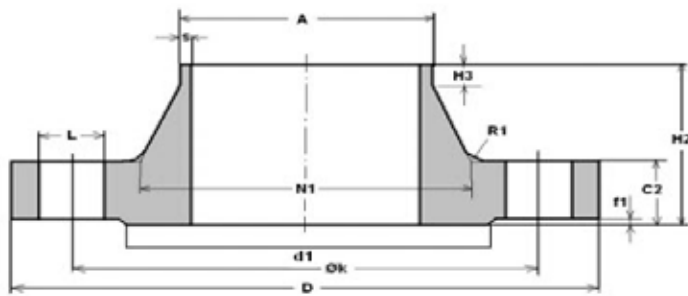

Voorlasflens EN 1092-1 TYPE11B1 PN 40

Maatvoering	D	C2	H2	H3	S	R1	A	N1	d1	Gaten	L	K	Kg
DN 10 / 17.2 mm	90,0	16	35	6	2,0	4	17,2	28,0	40,0	4	14	60,0	0,7
DN 15 / 20.0 mm	95,0	16	38	6	2,0	4	20,0	30,0	45,0	4	14	65,0	0,8
DN 15 / 21.3 mm	95,0	16	38	6	2,0	4	21,3	32,0	45,0	4	14	65,0	0,8
DN 20 / 25.0 mm	105,0	18	40	6	2,3	4	25,0	38,0	58,0	4	14	75,0	1,1
DN 20 / 26.9 mm	105,0	18	40	6	2,3	4	26,9	40,0	58,0	4	14	75,0	1,1
DN 25 / 30.0 mm	115,0	18	40	6	2,6	4	30,0	42,0	68,0	4	14	85,0	1,3
DN 25 / 33.7 mm	115,0	18	40	6	2,6	4	33,7	46,0	68,0	4	14	85,0	1,3
DN 32 / 38.0 mm	140,0	18	42	6	2,6	6	38,0	52,0	78,0	4	18	100,0	1,9
DN 32 / 42.4 mm	140,0	18	42	6	2,6	6	42,4	56,0	78,0	4	18	100,0	1,9
DN 40 / 44.5 mm	150,0	18	45	7	2,6	6	44,5	60,0	88,0	4	18	110,0	2,2
DN 40 / 48.3 mm	150,0	18	45	7	2,6	6	48,3	64,0	88,0	4	18	110,0	2,2
DN 50 / 57.0 mm	165,0	20	48	8	2,9	6	57,0	72,0	102,0	4	18	125,0	2,9
DN 50 / 60.3 mm	165,0	20	48	8	2,9	6	60,3	75,0	102,0	4	18	125,0	2,9
DN 65 / 76.1 mm	185,0	22	52	10	2,9	6	76,1	90,0	122,0	8	18	145,0	3,7
DN 80 / 88.9 mm	200,0	24	58	12	3,2	8	88,9	105,0	138,0	8	18	160,0	4,8
DN 100 / 114.3 mm	235,0	24	65	12	3,6	8	114,3	134,0	162,0	8	22	190,0	6,5
DN 125 / 139.7 mm	270,0	26	68	12	4,0	8	139,7	162,0	188,0	8	26	220,0	8,9
DN 150 / 168.3 mm	300,0	28	75	12	4,5	10	168,3	192,0	218,0	8	26	250,0	11,7
DN 200 / 219.1 mm	375,0	34	88	16	6,3	10	219,1	244,0	285,0	12	30	320,0	21,0
DN 250 / 273.0 mm	450,0	38	105	18	7,1	12	273,0	306,0	345,0	12	33	385,0	34,2
DN 300 / 323.9 mm	515,0	42	115	18	8,0	12	323,9	362,0	410,0	16	33	450,0	47,6
DN 350 / 355.6 mm	580,0	46	125	20	8,8	12	355,6	408,0	465,0	16	36	510,0	69,3
DN 400 / 406.4 mm	660,0	50	135	20	11,0	12	406,4	462,0	535,0	16	39	585,0	98,0
DN 450 / 457.2 mm	685,0	57	135	20	12,5	12	457,2	500,0	560,0	20	39	610,0	105,0
DN 500 / 508.0 mm	755,0	57	140	20	14,2	12	508,0	562,0	615,0	20	42	670,0	130,0
DN 600 / 609.6 mm	890,0	72	150	20	16,0	12	609,6	666,0	735,0	20	48	795,0	209,0